

L-series

Montage voorschrift

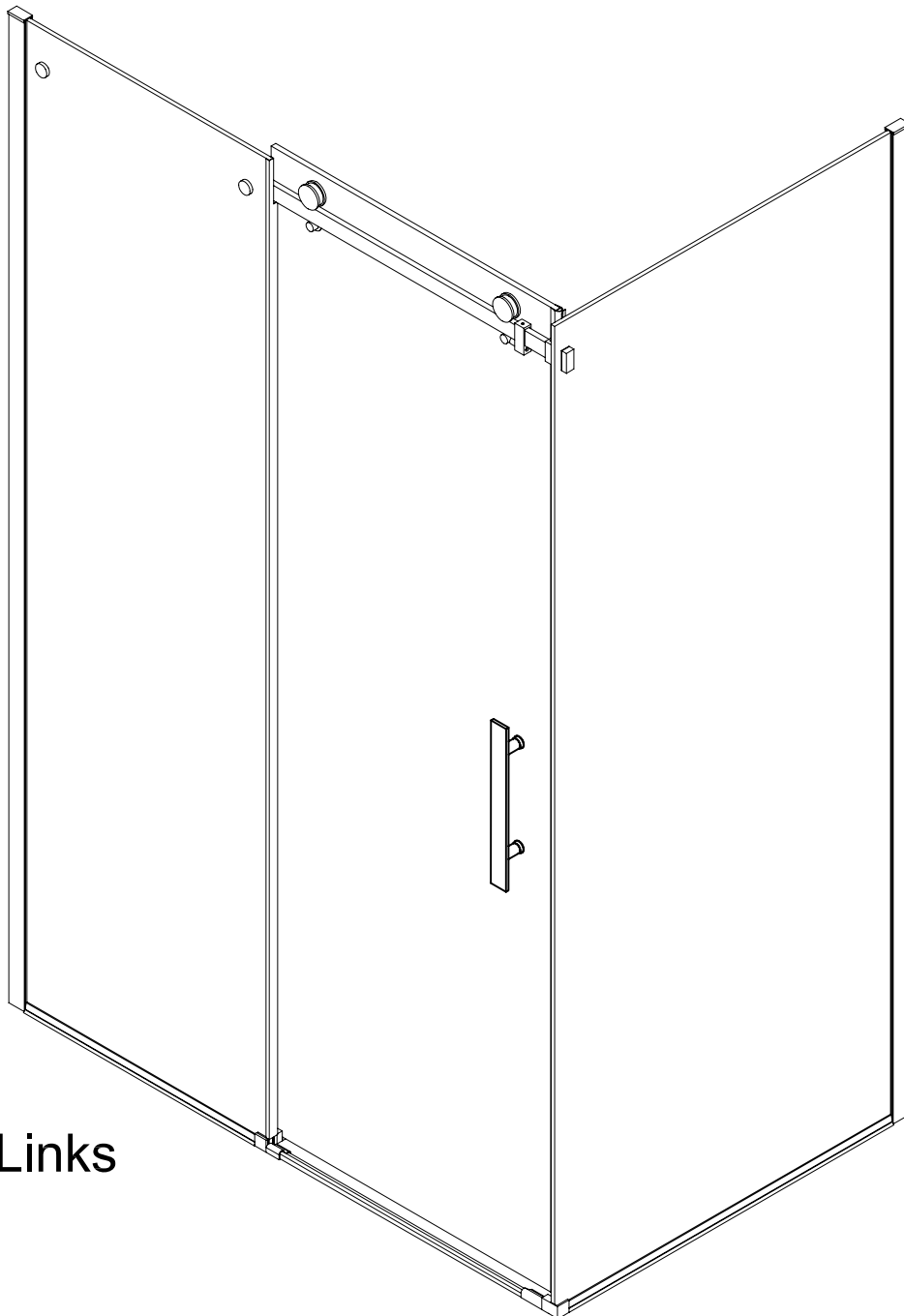

Model Links

Links Rechts montage

Lees deze handleiding goed door voor u met de montage begint.

1. Overtuigt u ervan dat u het benodigde gereedschap heeft
2. Controleer dat de plaats voor montage geschikt is
3. Controleer alle onderdelen van de douchewand op schade of fabricage fouten
4. Overtuigt u ervan dat de montageset compleet is

Indien er onderdelen beschadigt zijn of ontbreken, dient u uw leverancier binnen 2 dagen na de ontvangstdatum daarvan in kennis te stellen. Probeer NIET de douchewand te monteren zonder eerst de hierboven aangegeven 4 punten in acht te hebben genomen. NA MONTAGE VAN DE DOUCHEWAND KUNT U NIET MEER RECLAMEREN.

De muurpluggen die met de montageset meegeleverd worden, mogen alleen op stevige wanden gebruikt worden. Bij zogenaamde "scheidingswanden" dient u een andere bevestigingsmethode toe te passen. Wendt u tot een speciaalzaak voor verdere informatie over de juiste bevestigingsmethode. Soms is het voor de juiste boormethode noodzakelijk het advies in te winnen van uw tegelspecialist.

Overtuigt u ervan dat de douchebak of tegelvloer volkomen waterpas is en dat de muur nagenoeg haaks (90 graden) t.o.v. de vloer is. Alleen dan is de douchewand op de juiste manier te monteren.

Let erop met boren dat er geen leidingen beschadigd worden.

De beschermingsfolie op de profielen dienen voor montage verwijderd te worden.

Deze douchewand is zowel in de linker als rechter hoek te monteren.

Benodigheden

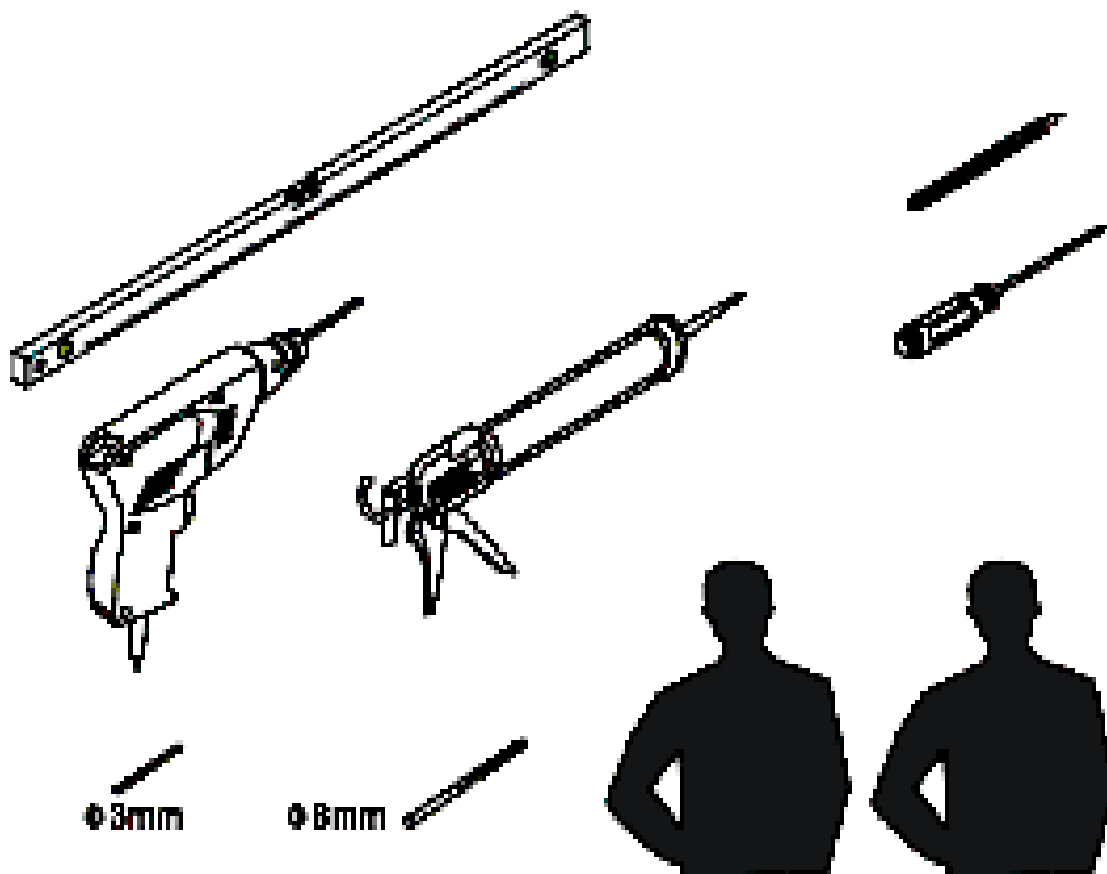

Dit product is zwaar en dient door twee personen gemonteerd te worden.

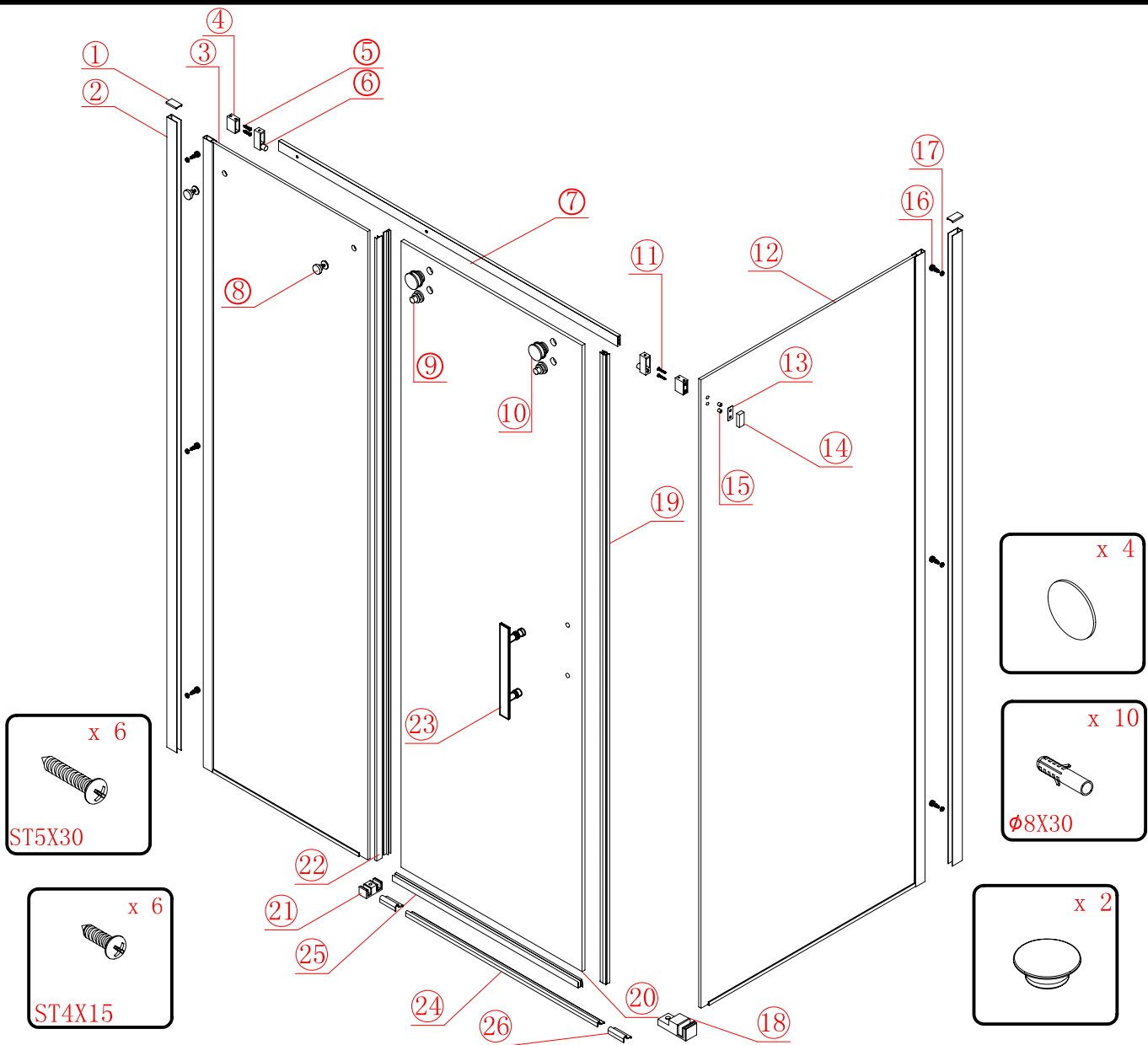

- | | | | | | | |
|-------|-------|-------|-------|-------|------------|------------|
| ① x 2 | ② x 2 | ③ x 1 | ④ x 2 | ⑤ x 4 | ⑥ x 2 | ⑦ x 1 |
| ⑧ x 2 | ⑨ x 2 | ⑩ x 2 | ⑪ x 2 | ⑫ x 1 | ⑬ x 2 | ⑭ x 1 |
| ⑮ x 2 | ⑯ x 6 | ⑰ x 6 | ⑱ x 1 | ⑲ x 1 | ⑳ x 1 | ㉑ x 1 |
| ㉒ x 2 | ㉓ x 1 | ㉔ x 1 | ㉕ x 1 | ㉖ x 2 | ST4X12 x 6 | ST4X20 x 2 |



Dit product is zwaar en dient door twee personen gemonteerd te worden.

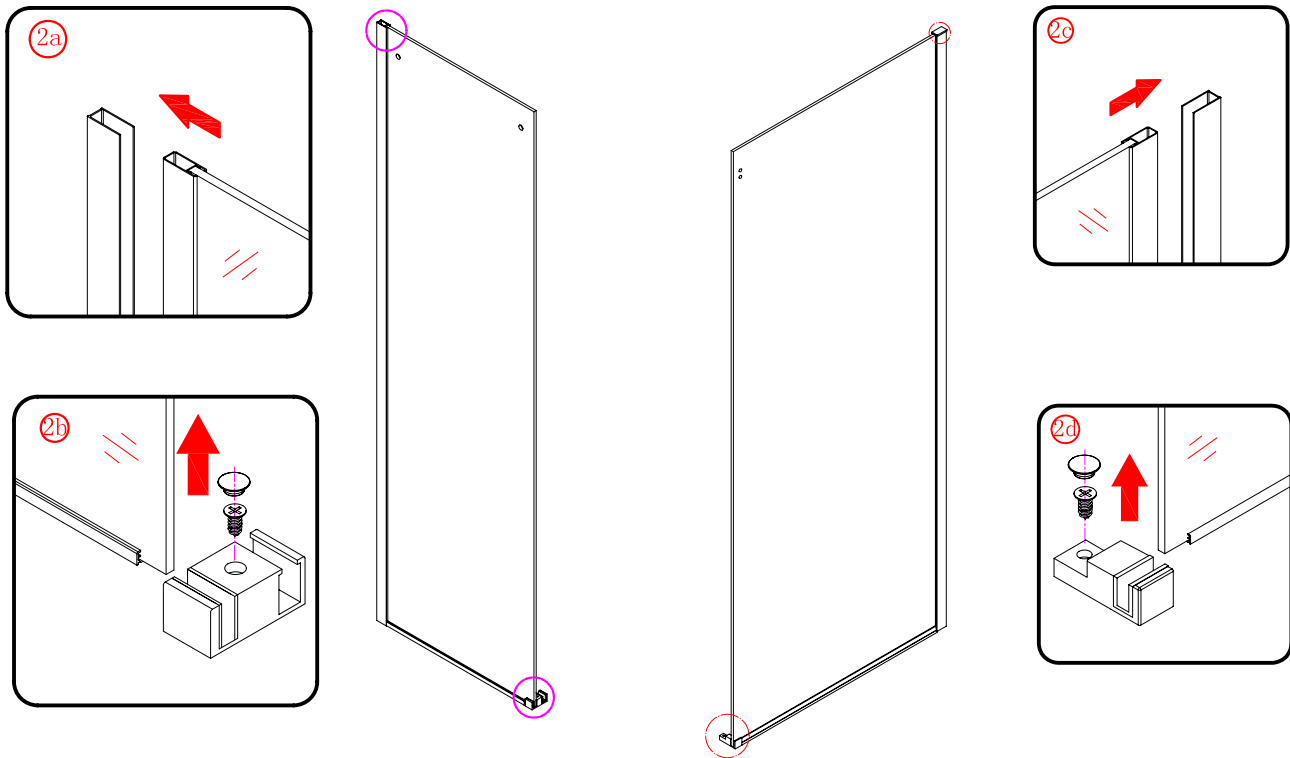
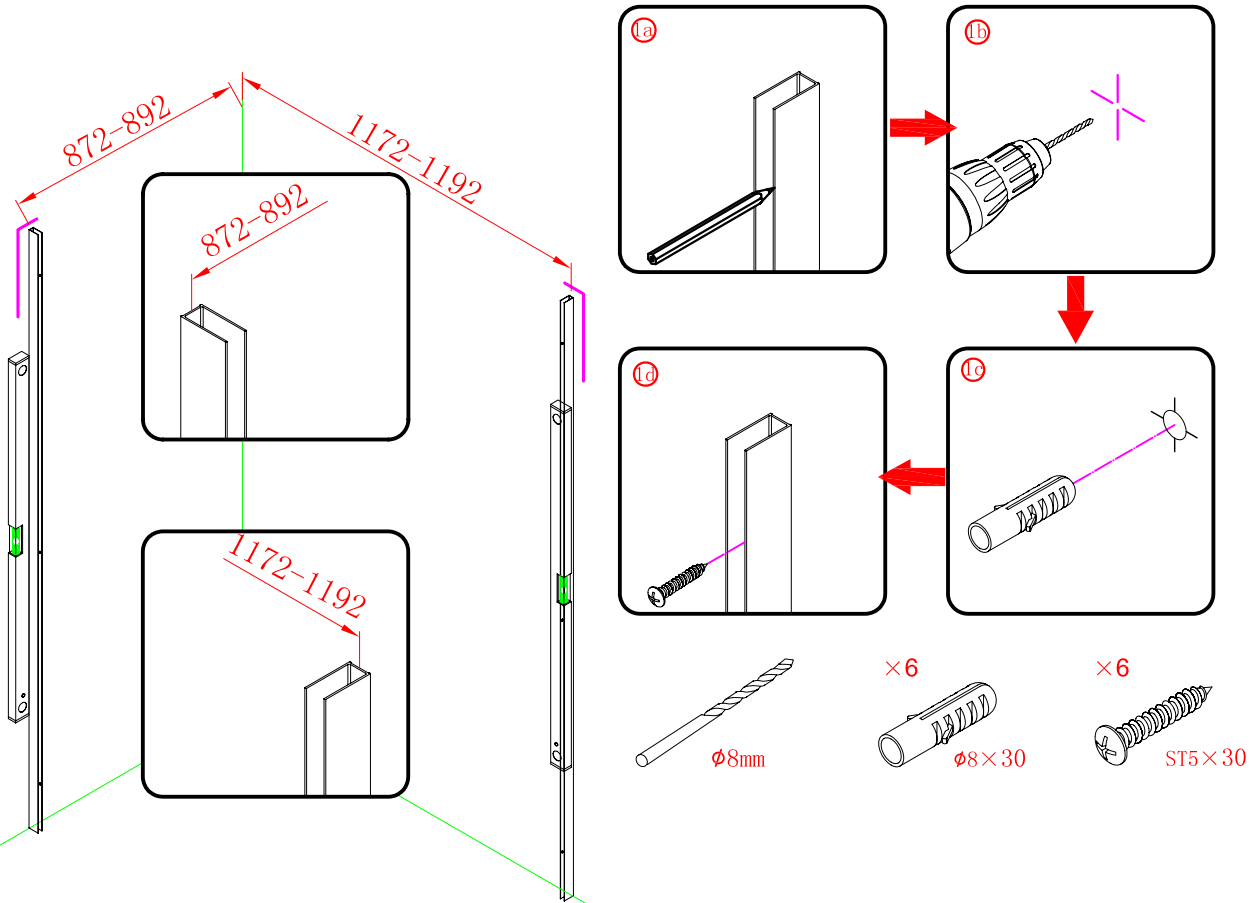

Dit product is zwaar en dient door twee personen gemonteerd te worden.

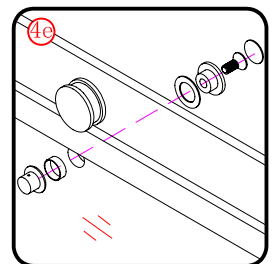
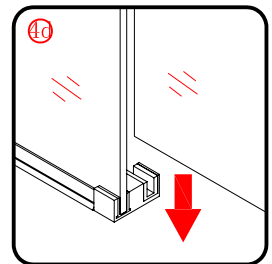
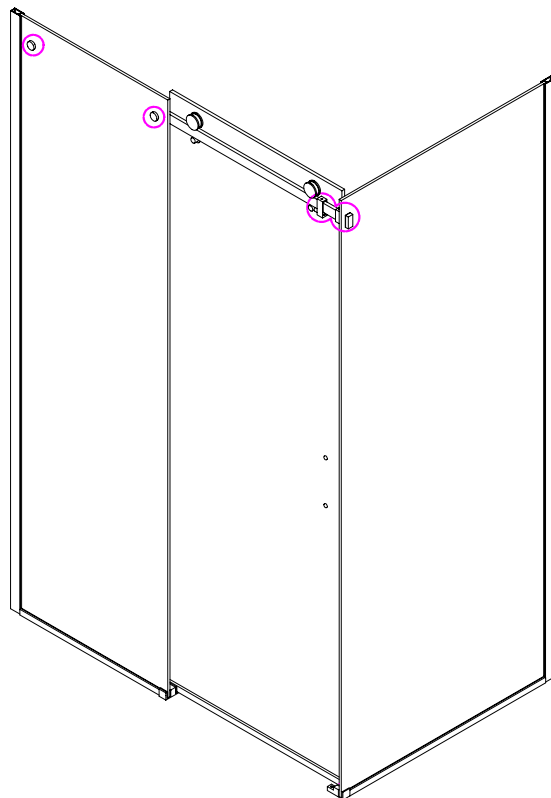
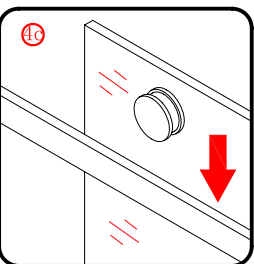
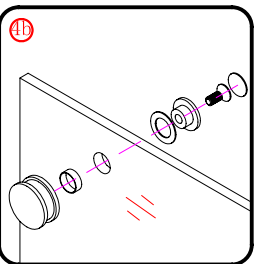
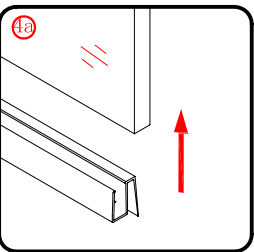
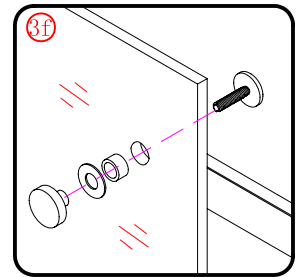
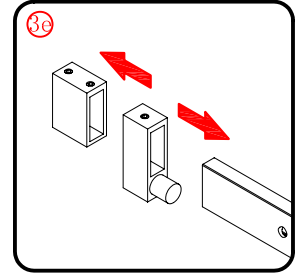
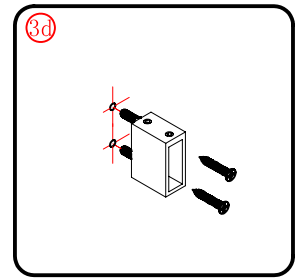
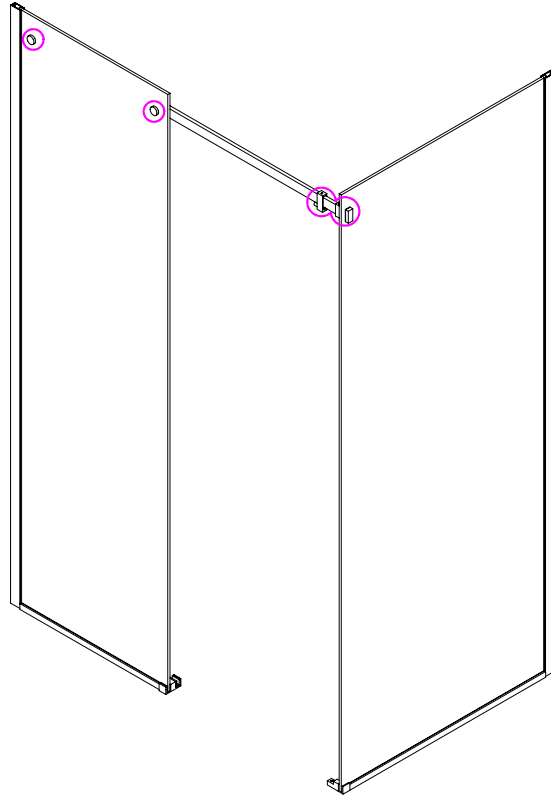
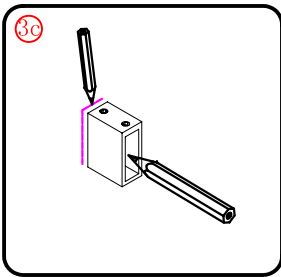
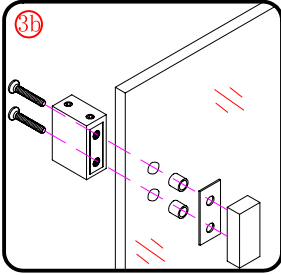
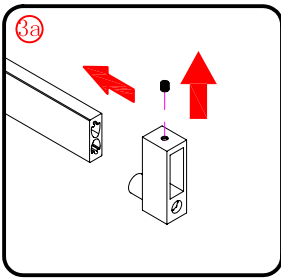

Dit product is zwaar en dient door twee personen gemonteerd te worden.

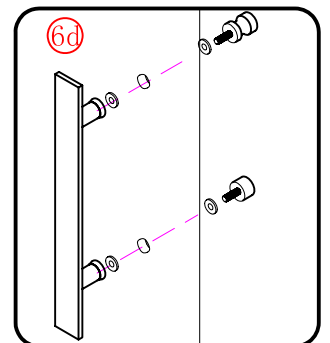
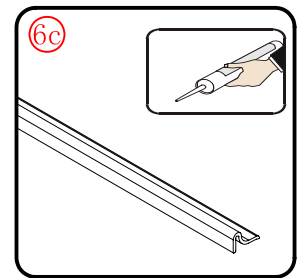
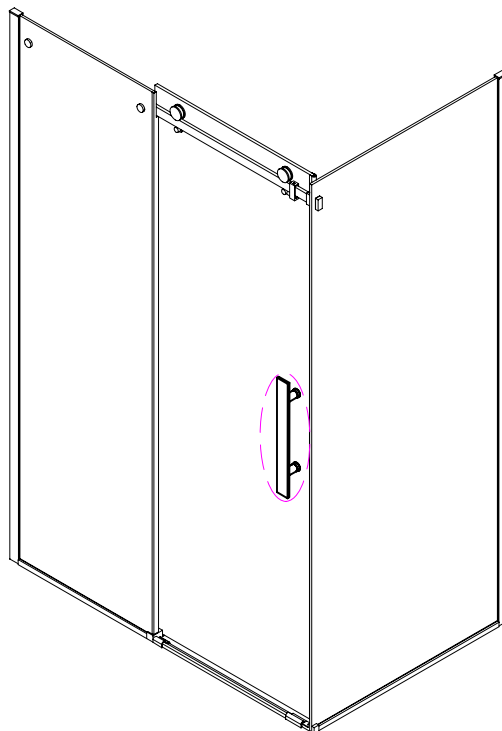
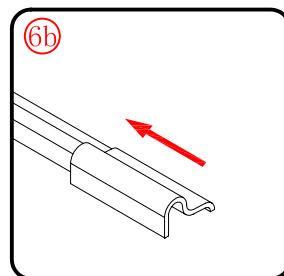
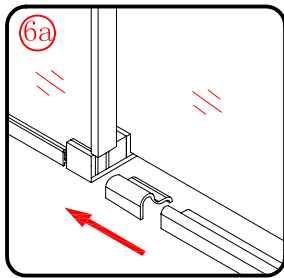
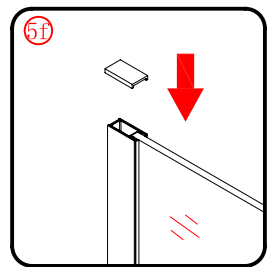
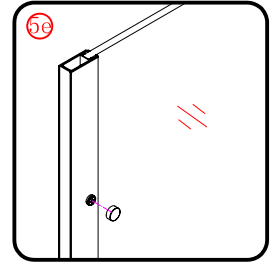
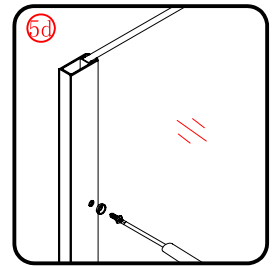
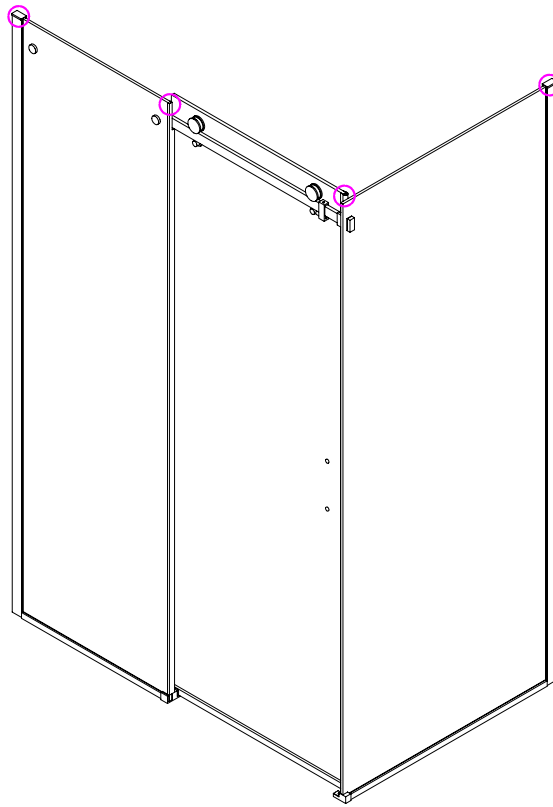
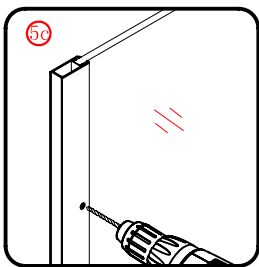
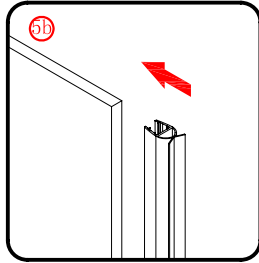
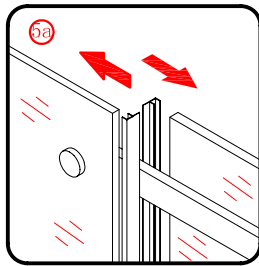

Dit product is zwaar en dient door twee personen gemonteerd te worden.

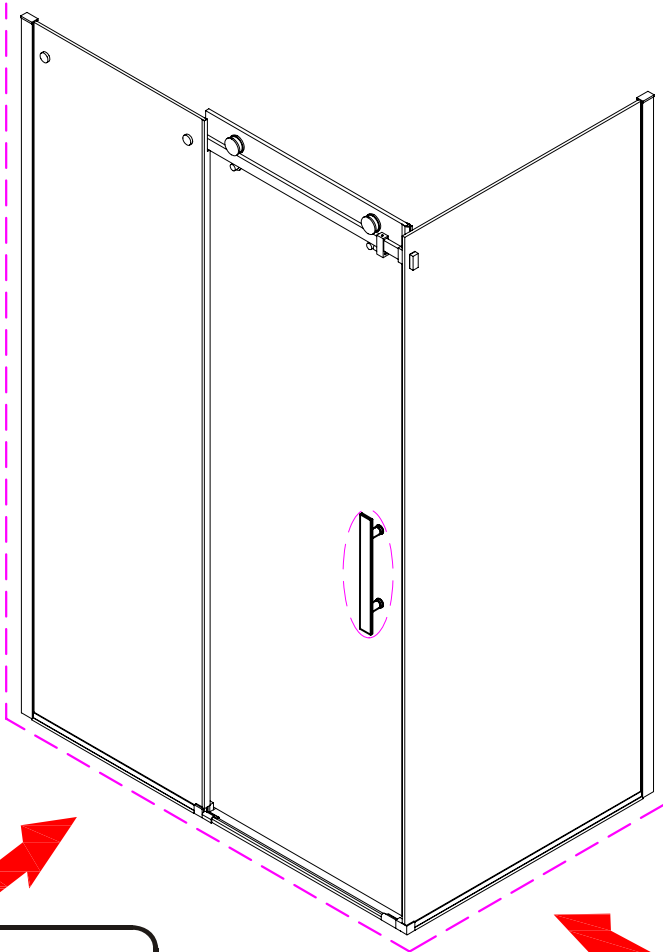
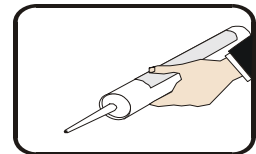
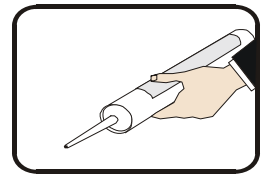
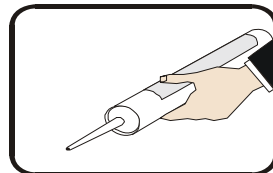
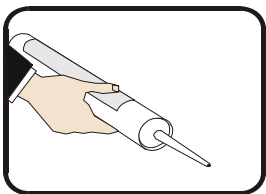
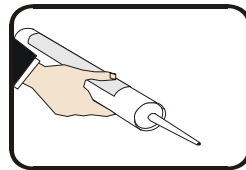
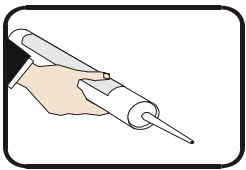

Dit product is zwaar en dient door twee personen gemonteerd te worden.